

PLEASE CHECK WWW.MOLEX.COM FOR LATEST PART INFORMATION

Part Number: [11-18-4785](#)
Status: **Active**
Description: Conductor Anvil

Documents:
[RoHS Certificate of Compliance \(PDF\)](#)

General

Product Family	Application Tooling
Series	T1118
Comments	See Tooling Specification (PDF) Above
Function	Cutter
Geographic Area	Global
Level of Automation	Semi-Automatic
More Detailed Tech Information	applicationtooling@molex.com
Product Name	N/A
Survey	www.molex.com//review/apptool_survey.html
Tool Type	Anvil
UPC	800753896314

Physical

Net Weight 5.400/g

Material Info

Old Part Number 60712C107

Reference - Drawing Numbers

Application Tooling Documents
 ATS-STANDARD-PARTS, TM-638000029,
 TM-638000029CN, TM-638000029DE,
 TM-638000029FR, TM-638000029IT,
 TM-638000029JP, TM-638000029KR,
 TM-638000029MY, TM-638000029PL,
 TM-638000029RU, TM-638000029SK,
 TM-638000029SP, TM-638000029TH,
 TM-638000029TW, TM-638000029VN, TM-638000100,
 TM-638000100SP
 60712C107

Sales Drawing

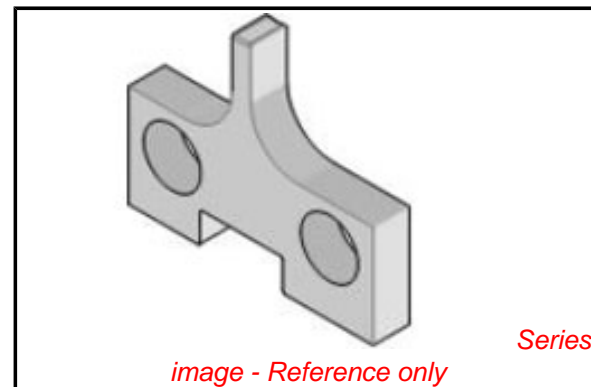

EU RoHS

**ELV and RoHS
 Compliant**
REACH SVHC
 Not Reviewed
Low-Halogen Status
 Not Reviewed

China RoHS



**Need more information on product
 environmental compliance?**

Email productcompliance@molex.com
 For a multiple part number RoHS Certificate of
 Compliance, [click here](#)

Please visit the [Contact Us](#) section for any
 non-product compliance questions.

Search Parts in this Series

T1118Series

Use With

11-18-2023 , 11-18-3022 , 63888-1100 ,
 63888-1170