

Housing - HC-B 32-SFS-72-O1M32-EEE - 1580526

Please be informed that the data shown in this PDF Document is generated from our Online Catalog. Please find the complete data in the user's documentation. Our General Terms of Use for Downloads are valid (<http://phoenixcontact.com/download>)



HEAVYCON-ADVANCE pedestal enclosure B 32, for increased environmental requirements, EMC-conductive, for Allen wrench screw locking, with 1x M32x1.5 cable outlet



Key Commercial Data

Packing unit	6 STK
GTIN	 4 046356 463225
GTIN	4046356463225

Technical data

Dimensions

Height	72 mm
Width	94 mm
Length	138 mm

Ambient conditions

Degree of protection of housing (IP)	IP66
	IP68 (0.2 bar/24 h)
	IP69K
Degree of protection of housing (NEMA)	4
	4X
	6P
	12
Ambient temperature (operation)	-40 °C ... 125 °C

General

Note	For contact inserts HC-B32, DD144, M
Size	B32

Housing - HC-B 32-SFS-72-O1M32-EEE - 1580526

Technical data

General

Housing type	Box mounting bases
Locking type	Screw locking
Fixing screws	M6 (5 mm Allen screw)
No. of cable outlets	1
Cable outlet	lateral
Screw connection	none
Type of the screw connection	1x M32
Housing material	Die-cast aluminum, salt water resistant
Housing surface material	uncoated

Drawings

Dimensional drawing

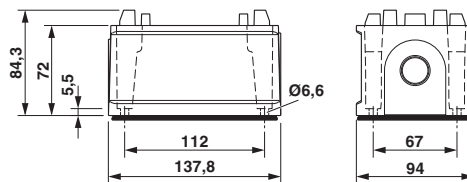

Dimensional drawing

Approvals

Approvals

Approvals

EAC

Ex Approvals

Approval details

EAC		RU C- DE.AI30.B.01102
-----	--	--------------------------

Phoenix Contact 2018 © - all rights reserved
<http://www.phoenixcontact.com>

PHOENIX CONTACT GmbH & Co. KG
Flachsmarktstr. 8
32825 Blomberg
Germany
Tel. +49 5235 300
Fax +49 5235 3 41200
<http://www.phoenixcontact.com>