

PART NUMBER SEE SHEET 2

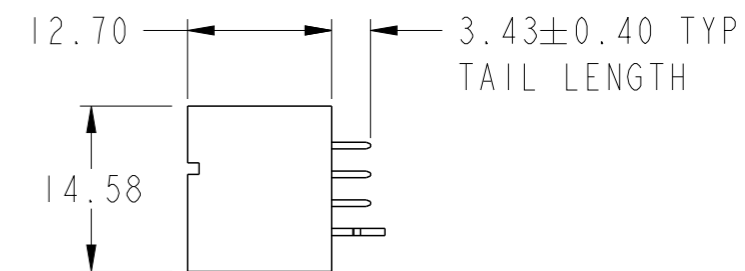

| | | | | | | | | | | | | | | | | | | | | |
|---------------------------------------|---|-------------|--------------|-----------------------------|------------------------|--------------|--------|------------------|-----------|----------|---------|----|-----|------|----------------|------------|----------------|-----------|-----------|----------|
| spec ref | * | dr | Zhao Peter | 2012/12/07 | projection | MM | size | A3 | scale | 3:2 | | | | | | | | | | |
| tolerance std | ASME Y14.5 | eng | Peng-Bing Fu | 2013/03/11 | | | ecn no | - | rel level | Released | | | | | | | | | | |
| TOLERANCES UNLESS OTHERWISE SPECIFIED | | chr | - | - | | | | | | | | | | | | | | | | |
| surface | <table border="1"> <tr> <td>linear</td> <td>0.X</td> <td>±0.5</td> </tr> <tr> <td></td> <td>0.XX</td> <td>±0.25</td> </tr> <tr> <td></td> <td>0.XXX</td> <td>±0.10</td> </tr> <tr> <td>angular</td> <td>0°</td> <td>±2°</td> </tr> </table> | linear | 0.X | ±0.5 | | 0.XX | ±0.25 | | 0.XXX | ±0.10 | angular | 0° | ±2° | appr | Pei-Ming Zheng | 2013/03/11 | product family | PwrBlade+ | rel level | Released |
| linear | 0.X | ±0.5 | | | | | | | | | | | | | | | | | | |
| | 0.XX | ±0.25 | | | | | | | | | | | | | | | | | | |
| | 0.XXX | ±0.10 | | | | | | | | | | | | | | | | | | |
| angular | 0° | ±2° | | | | | | | | | | | | | | | | | | |
| ASME Y14.5 | | www.fci.com | cat. no. | 3HDP PB+ VERTICAL HEADER | Product - Customer Drw | sheet 1 of 3 | dwg no | 10106128-3000001 | rev | A | | | | | | | | | | |

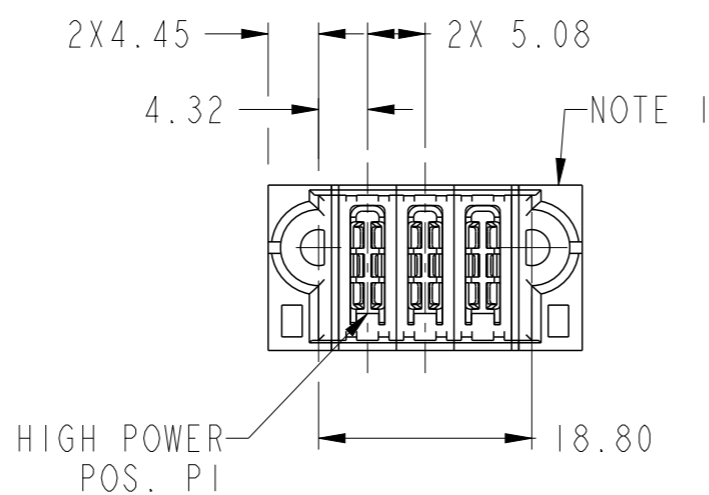
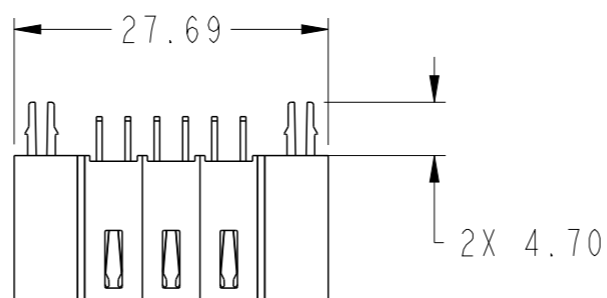
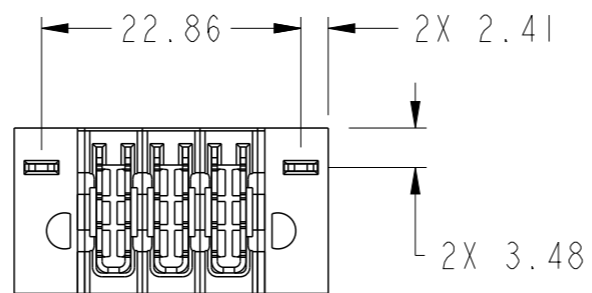

Copyright FCI.

PRODUCT NO.

10106128-3000001LF

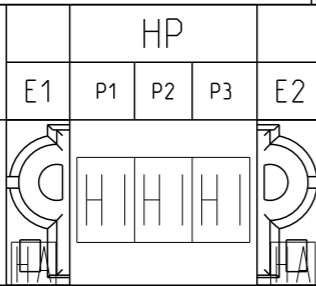

| CODE | DESCRIPTION |
|------|------------------------|
| HI | STD HIGH POWER CONTACT |
| HA | METAL HOLD DOWN |

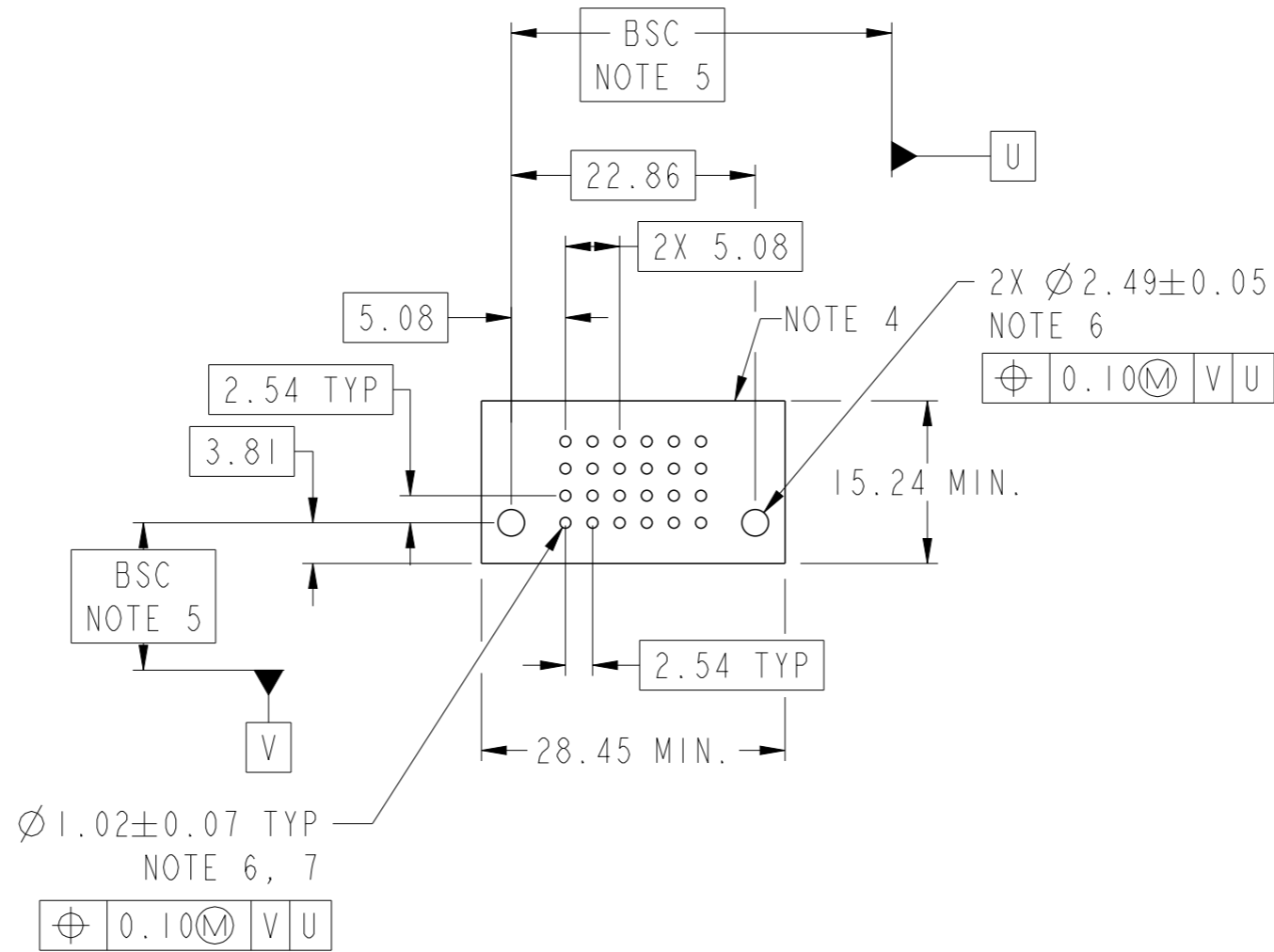

V
 U

W

| | | | | | | | | |
|-------------|----------------|--------------------------------------|------------------------|----------------------------|--------------|----------|-------|-----|
| dr | Zhao Peter | 2012/12/07 | projection | MM | size | A3 | scale | 3:2 |
| eng | Peng-Bing Fu | 2013/03/11 | | | ecn no | - | | |
| chr | - | - | | | rel level | Released | | |
| appr | Pei-Ming Zheng | 2013/03/11 | product family | PwrBlade+ | | | | |
| | | title 3HDP PB+ VERTICAL HEADER | | dwg no 10106128-3000001 | rev A | | | |
| www.fci.com | | cat. no. | Product - Customer Drw | | sheet 2 of 3 | | | |



Copyright FCI.

A

B

C

D

A

B

C

D

NOTES:

- 1) "FCI", PART NUMBER AND DATE CODE TO BE MARKED ON THIS SURFACE.
THE MARK CAN BE OMITTED IF THERE IS NOT ENOUGH SPACE ON THIS SURFACE.
- 2) MATERIALS:
-HOUSING - GLASS FILLED WITH HIGH TEMP THERMOPLASTIC, UL94V-0.
-SIGNAL CONTACT - COPPER ALLOY.
-POWER CONTACT - HIGH CONDUCTIVITY COPPER ALLOY.
- 3) PLATING SPECIFICATION REFER TO FCI 10116351
- 4) DENOTES CONNECTOR KEEP OUT ZONE.
- 5) DATUM AND BASIC DIMENIONS WERE ESTABLISHED BY CUSTOMER.
- 6) ALL HOLE DIAMETERS ARE FINISHED HOLE SIZES.
- 7) 1.15±0.025MM DRILLED HOLE PLATED WITH 0.00762MM MIN Sn
OVER 0.0254-0.0762MM Cu PLATING TO ACHIEVE A 1.02±0.07MM HOLE.
- 8) PRODUCT SPECIFICATION REFER TO FCI GS-12-658.
APPLICATION SPECIFICATION REFER TO FCI GS-20-141.
PRODUCT PACKAGED IN TRAYS, REFER TO FCI GS-14-1502.



Copyright FCI.

| | | | | | | | | |
|------|----------------|--------------------------------------|-------------------------|-----------------------------------|----------------------------|----------|--------------|-----|
| dr | Zhao Peter | 2012/12/07 | projection | MM | size | A3 | scale | 3:2 |
| eng | Peng-Bing Fu | 2013/03/11 | | | ecn no | - | | |
| chr | - | - | | | rel level | Released | | |
| appr | Pei-Ming Zheng | 2013/03/11 | product family | PwrBlade+ | | | | |
| | | title 3HDP PB+ VERTICAL HEADER | cat. no. www.fci.com | product Product - Customer Drw | dwg no 10106128-3000001 | rev A | sheet 3 of 3 | |