

PART NUMBER	REV	FIRST USED
567970-1	B	854040-3

TERMINAL NAME: (AMP TERMINAL)					
VISIBLE PAD LTR	917308 917309	CRIMP DATA (NON-AMP TERM-CUST SPEC)			
		CRIMP HEIGHT	WIRE SIZE		
A	.040 ±.002 [1.02 ±0.05mm]	0.5mm ²			
B	.035 ±.002 [0.89 ±0.05mm]	0.3mm ²			
C	NOT	USED			
D	NOT	USED			
CRIMP	SIZE	TYPE	RANGE		
WIRE	.050 [1.27mm]	F	0.3-0.5mm ²		
INSUL	.055 [1.40mm]	F	Ø1.4-Ø1.7MM		
WIRE STRIP LENGTH	TERM APPL SPEC	FEED	APPL INSTRUCTION	SET UP GAGE	LAYOUT
.118	114-5193	.272	SEE CUSTOMER MANUAL	NONE	L2016

SIM TO HDM 680559					
REF	QTY	REV	PART NO	DESCRIPTION	ITEM NO
					70
					69
					68
					67
					66
					65
					64
					63
					62
					61
					60
					59
					58
					57
					56
					55
					54
					53
					52
					51
					50
					49
					48
					47
					46
					45
					44
					43
					42
					41
					40
					39
					38
					37
					36
					35
					34
					33
					32
					31
					30
					29
					28
					27
					26
					25
					24
					23
					22
					21
					20
					19
					18
					17
					16
					15
					14
					13
					12
					11
					10
					9
					8
					7
					6
					5
					4
					3
					2
					1

QTY	REV	TER	PART NO	DESCRIPTION	ITEM NO
2	-	C	5-354779-4	PIN, WIRE DISC (.3260)D	129
2	-	C	4-354779-4	PIN, WIRE DISC (.3210)C	128
					127
					126
1	-	A	986950-1	WASHER, FLAT PRECISION	125
1	-	A	217238-3	GENERAL INSTRUCTION PACKAGE	124
					123
					122
1	-	A	4-21028-0	PIN, SLT SPR (Ø.093x.75) ST 6DE PL	121
1	-	B	690701-2	PLATE, SERIAL NO.	120
2	-	A	21899-2	WASHER, FLAT (#10) S G ADJ BLK	119
					118
2	-	A	21024-5	WASHER, LOCK (#10) ADJ BLOCK	117
					116
					115
2	-	A	21024-2	WASHER, LOCK (#4) FRONT STP GUIDE	114
REF	-	A	21024-4	WASHER, LOCK (#8) FEED FINGER	113
2	-	A	21024-4	WASHER, LOCK (#8) DEP-HOLD	112
REF	-	A	21024-4	WASHER, LOCK (#8) STRIPPER	111
					110
					109
1	-	A	21018-5	NUT, HEX (#6) HOLD DOWN	108
					107
					106
					105
1	-	A	21009-2	SCR, SKT 5ET (1/4-20x.25 LW) RAM	104
					103
					102
4	-	A	21017-2	SCR, DRIVE (#2x.19) ID PLATE	101
1	-	B	819347-1	PLATE, IDENTIFICATION	100
2	-	A	3-21002-0	SCR, BHC (10-32x.88) DRAG	99
1	-	A	22733-8	SCR, BHC (8-32x.38 LW) ANVIL	98
					97
1	-	A	3-21000-8	SCR, SHC (10-32x.88) MOUNTING	96
1	-	A	2-21002-7	SCR, BHC (10-32x.50) S6 ADJ BLK	95
6	-	A	2-21002-2	SCR, BHC (8-32x.50) SHEAR-TERM SUP	94
					93
					92
1	-	A	1-21002-7	SCR, SHC (6-32x.50) CAM	91
2	-	A	2-21000-8	SCR, SHC (8-32x.62) SCR BLK	90
					89
					88
2	-	A	2-21000-8	SCR, SHC (8-32x.62) DEP-HOLD DOWN	87
REF	-	A	2-22603-0	SCR, HEX HD (8-32x.31) FEED FINGER	86
2	-	A	1-21000-3	SCR, SHC (4-40x.25) F ST GUIDE	85
REF	-	A	22733-9	SCR, BHC (8-32x.50 SL) STRIPPER	84
					83
					82
1	-	A	3-22603-1	SCR, HEX (10-32x.38) S6 ADJ BL	81
					80
					79
					78
2	-	B	463310-5	BLADE, STRIPPING (#20)	77
					76
					75
1	-	A	690603-1	SPRING, ASSIST	74
1	-	A	23030-1	SCR, SKT CAP (6-32x.25) CP DSC	73
					72
					71

QTY	REV	U/M	DWG SIZE	PART NO	DESCRIPTION	ITEM NO

PARTS LIST			
QTY	REV	U/M	DWG SIZE

REVISION OF EACH ASSY NO (WHEN BLANK, USE DWG REVISION)			
QTY	REV	U/M	DWG SIZE

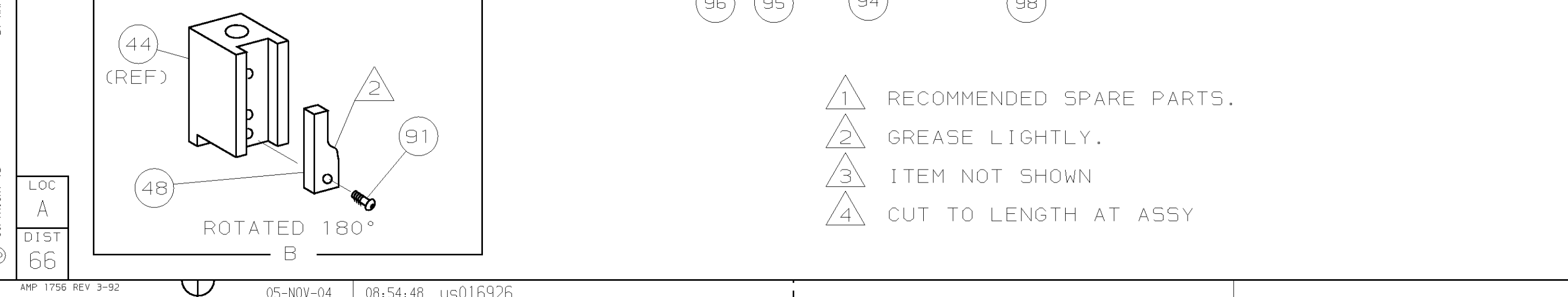
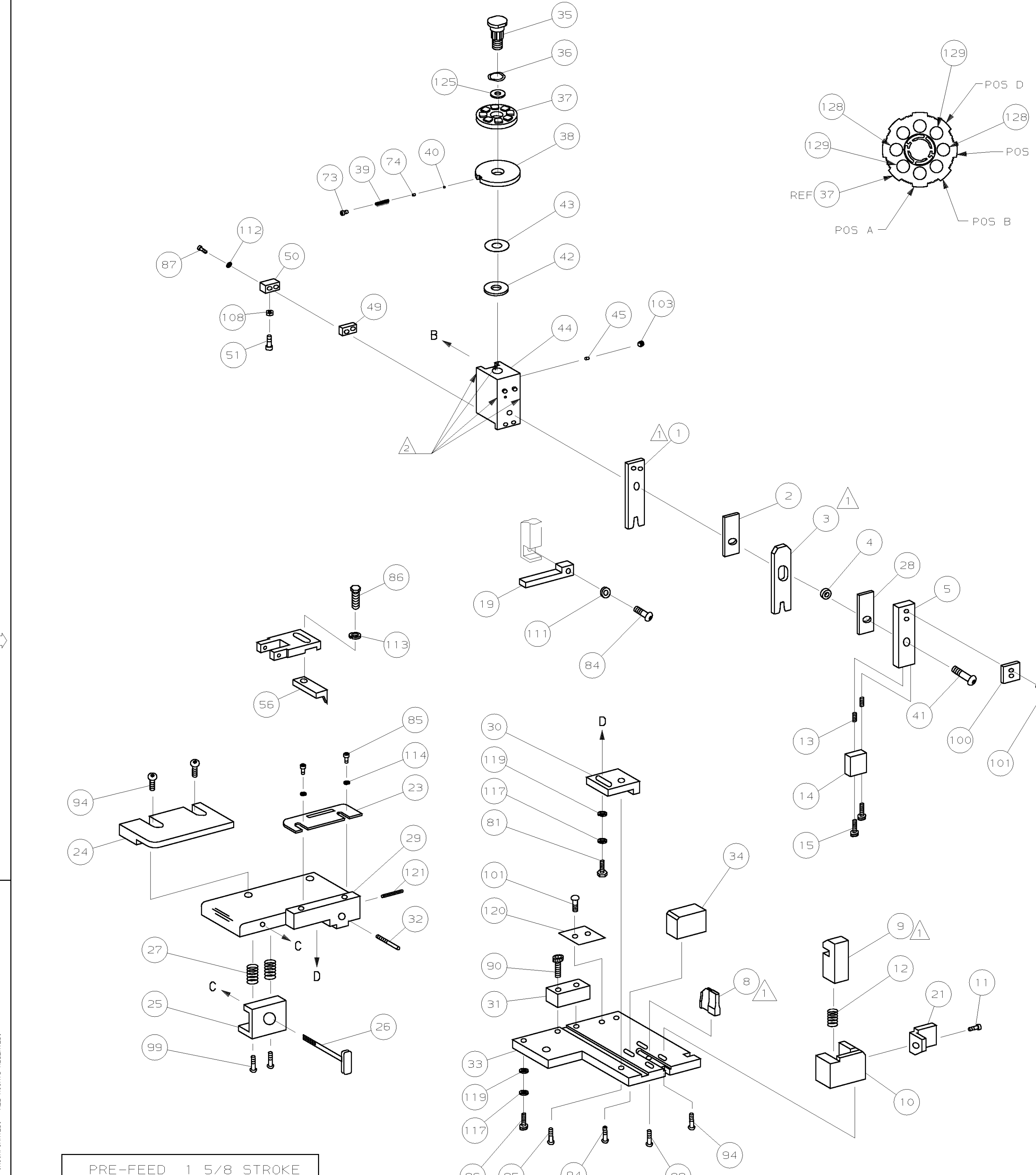

▲1 RECOMMENDED SPARE PARTS.
 ▲2 GREASE LIGHTLY.
 ▲3 ITEM NOT SHOWN
 ▲4 CUT TO LENGTH AT ASSY

THIS DRAWING IS A CONTROLLED DOCUMENT.

THIS DRAWING IS UNRELEASED. RELEASED FOR PUBLICATION BY AMP INCORPORATED. ALL RIGHTS RESERVED. © COPYRIGHT 19

LOC A DTST 66

567970