

SECTION: A-A'

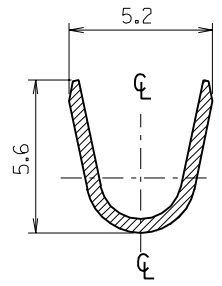

SECTION: B-B'

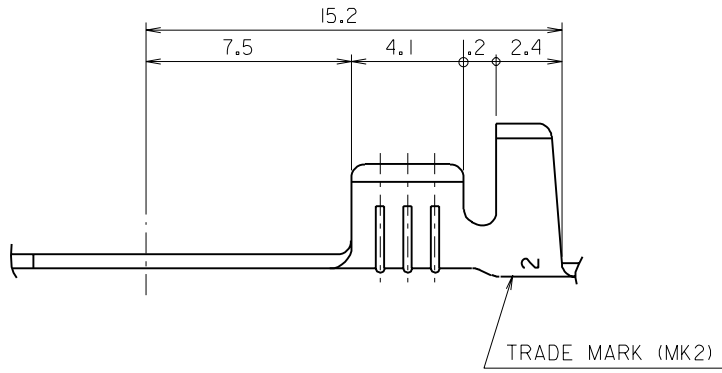

NOTES

1. MATERIAL: BRASS 0.5 THK'
2. FINISH: 35750-1200: NONE
35750-1210: POST-TIN PLATING
35723-1004: TIN LEAD PLATING
3. RECOMMENDED LENGTH OF WIRE STRIP IS 5.4-6.0

		ASS'Y PART		QTY/REEL OR PACK		SURFACE AREA		MATERIAL		SEE NOTE		WIRE RANGE		GENERAL TOLERANCES		MOLEX-KOREA CO.,LTD.	
		DESCRIPTION		5,000 O'TY /REEL		MM ²		DIMENSION CLASSIFICATION				AWG: #18-#14		DIM. : +0.3			
								LAYOUT NO.		<input checked="" type="checkbox"/> : CRITICAL <input checked="" type="checkbox"/> : MAJOR <input type="checkbox"/> : MINOR () : REFERENCE		INSULATION RANGE		TITLE: Ø 5.4 RING TERMINAL		IOF I	
C REVISED		YANG 92.4.30				DIE NO. ---		DRAWN BY W.Y.YANG		CHK'D BY B.K.CHOI		∅3.2 MAX.		ENG.NO. SD 35750-12*0		REV C	
B REVISED		YANG 91.12.3				WIRE CRIMP WIDTH ---		INS. CRIMP WIDTH ---		APP'D BY		SCALE CAD (6:1)					
A CAD DRAWING RELEASED		YANG 91.11.2				IBDW ---											
LTR	REVISION RECORD	ECN	DR. /CHK	DATE	DIE FEED	APPL FEED	WBDW	IBDW	APP'D BY	SCALE							