



P/Ns 1109522 and 1109523 DIP-to-JEDEC TO Adapter Socket

FEATURES

- 8-pin DIP IC Socket on the top and a circular, 8-pin JEDEC TO male pin footprint on the bottom. ICs now available only in 8-pin DIPs can be readily-mounted on boards having JEDEC TO thru-hole footprints without having to redesign the board.

GENERAL SPECIFICATIONS

- SOCKET BODY: black UL 94V-0 glass-filled 4/6 Nylon 170°C continuous use temp.
- ADAPTER BOARD: FR-4, 0.062 [1.58] thick
- FEMALE PIN: Brass 360 1/2-hard per UNS C36000, ASTM B16/B16M
- FEMALE PIN PLATING: 10µ [0.25µ] min. Au per MIL-G- 45204 over 100µ [2.54µ] Ni per SAE-AMS-QQ-N- 290
- FEMALE PIN CONTACT: BeCu per UNS C17200, ASTM B194-08
- FEMALE PIN CONTACT PLATING: 10µ [0.25µ] Au per MILG- 45204 over 50µ [1.27µ] Ni per SAE-AMS-QQN- 290
- MALE PIN: Brass 360 1/2-hard per UNS C36000, ASTM B16/B16M
- MALE PIN PLATING: 200µ [5.08µ] Sn/Pb 93/7 per ASTM B579-73 over 100µ [2.54µ] Ni per SAE-AMS-QQ-N-290
- CURRENT RATING: 3 amps
- OPERATING TEMPERATURE: 221°F [105°C] 1109522
- INSERTION FORCE: 180 grams/pin; based on a 0.018 [0.46] dia. test lead
- WITHDRAWAL FORCE: 90 grams/pin; based on a 0.018 [0.46] dia. test lead
- NORMAL FORCE: 140 grams/pin; based on a 0.018 [0.46] dia. test lead
- ACCEPTS: leads 0.015-0.025 [0.38-0.64] in dia., 0.100-0.125 [2.54-3.18] long

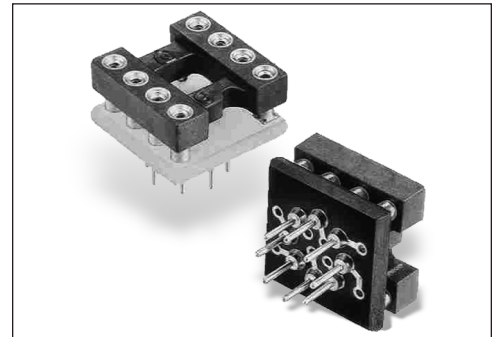

CUSTOMIZATION: In addition to the standard products shown on this page, Aries specializes in custom design and production. Special materials, platings, sizes, and configurations can be furnished, depending on the quantity. **NOTE:** Aries reserves the right to change product general specifications without notice.

ORDERING INFORMATION

P/N 1109522

P/N 1109523 see Pin Layouts Below

MOUNTING CONSIDERATIONS

- SUGGESTED PCB HOLE SIZE: 0.028 ±0.002 [0.71 ±0.05] dia.

ALL DIMENSIONS: INCHES [MILLIMETERS]

ALL TOLERANCES: ±0.005 [0.13] UNLESS OTHERWISE SPECIFIED

CONSULT FACTORY FOR OTHER SIZES AND CONFIGURATIONS

PIN LAYOUTS

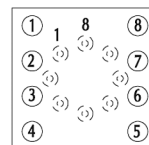

Part No. 1109522

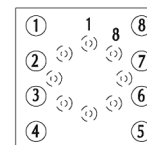

Part No. 1109523

All tolerances ± .005 [.13] unless otherwise specified

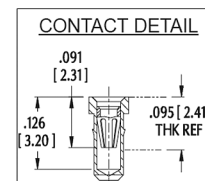
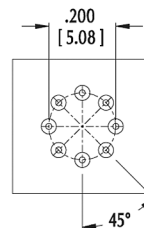
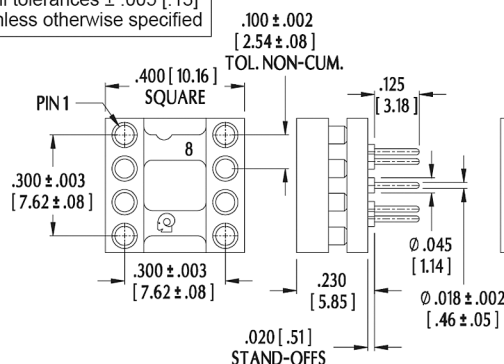

Bristol, PA 19007-6810 USA
 TEL (215) 781-9956 • FAX (215) 781-9845
 WWW.ARIESELEC.COM • INFO@ARIESELEC.COM