

LOADING PATTERN MATING SIDE

f	0	0	0	0	0	0	0	0	0	0	0	0	0	0	0	0	0	0	0	0
e	5	5	5	5	5	5	4	4	5	5	5	5	5	5	5	5	5	5	5	5
d	5	5	5	5	5	5	5	4	4	5	5	5	5	5	5	5	5	5	5	5
c	5	5	5	5	5	5	5	5	4	5	4	4	5	4	4	5	5	5	5	5
b	5	5	5	5	5	5	5	4	4	5	5	5	5	5	5	5	5	5	5	5
a	5	5	5	5	5	5	4	4	5	5	5	5	5	5	5	5	5	5	5	5
z	0	0	0	0	0	0	0	0	0	0	0	0	0	0	0	0	0	0	0	0
P	0	0	1	1	2	2														
S	1	5	0	5	0	5														

LOADED CONNECTOR ASSEMBLY (FOR EXAMPLE)

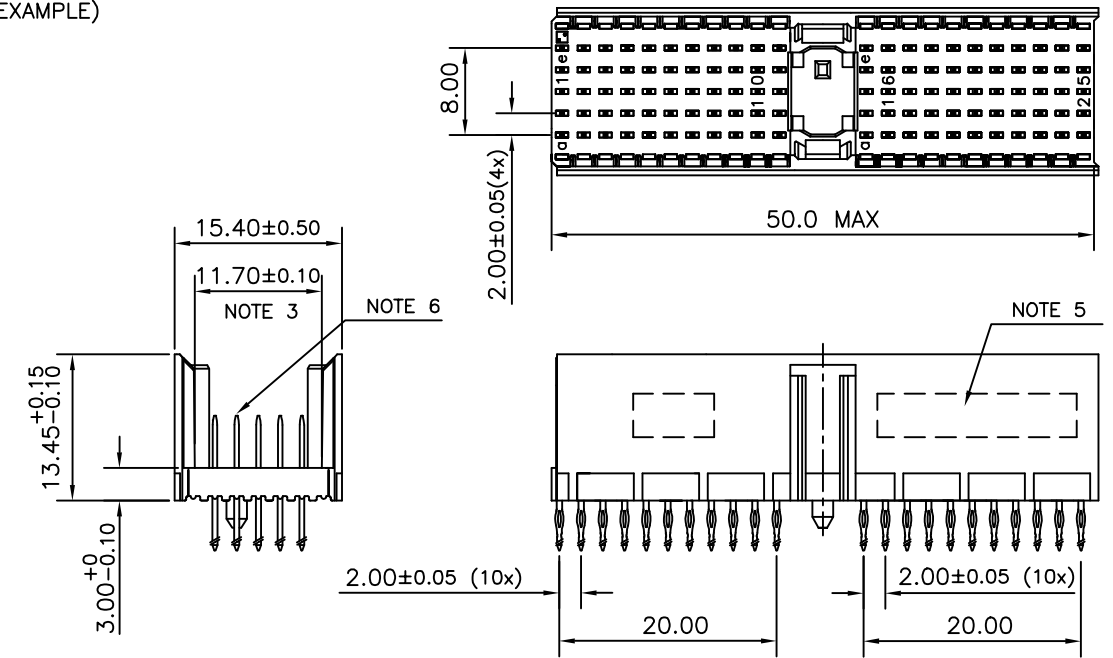

CONTACT OVERVIEW

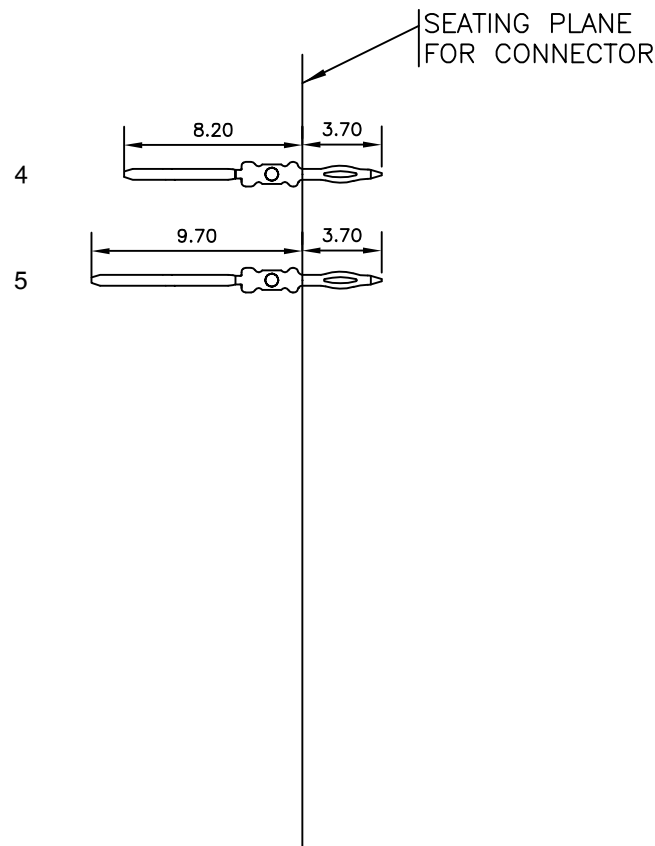

LAY-OUT P.C.B.-HOLE

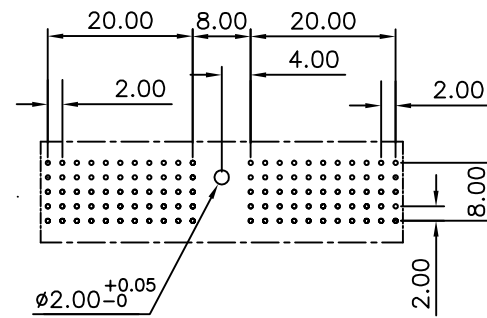

HM2P07PDF3C0-
 LEAD FREE INDICATOR : LF = LEAD FREE (DIGIT 15 & 16)
 PLATING CODE (DIGIT 13 AND 14) (REF DRW NO. BS,C , 201844 , 003)

NOTES

- THIS PRODUCT IS CSA APPROVED.
 - THIS PRODUCT IS UL RECOGNIZED.
 - MEASURED AT THE BOTTOM.
 - MATERIAL CONTACT: PHOSPHORBRONZE
HOUSING: CREAM WHITE GLASS FILLED POLYESTER UL-94V0
 - CONNECTOR PRINTED WITH P/N AND DATE CODE.
 - FOR ACTUAL CONTACT LOADINGS, SEE LOADING PATTERN MATING SIDE.
 - SHAPE OF CONNECTOR HOUSING CAN ALTER DEPENDING ON PRODUCTION LOCATION
 - THE PRODUCT (LF) MEETS EUROPEAN UNION DIRECTIVES AND OTHER COUNTRY REGULATIONS AS DESCRIBED IN GS-22-008
 - FOR RECOMMENDED PTH DIMENSIONS REFER DRAWING : BS, A , 201572 , 001
- CATALOG NO: HM2P07PDF3C0----

mat'l. code SEE NOTE 4				surface ISO 1302 ✓		tolerance ISO 406 ISO 1101		projection MM		product family MILLIPACS			
litr				ecn no		dr		date		tolerances unless otherwise specified		title	
A				I04-0093		MINI		2004/10/15		angles		MPACS 5+2R STR HDR PF CONN TYPE A	
B				I05-0190		MINI		2005/10/13		linear		MM	
C				I06-0090		MINI		2006/06/28		0°±1°		scale -	
						dr		MINI K VANDANATH 2004/10/15		dwg no		sheet 1 of 1 size 5	
						enr		BIJU K PAUL 2004/10/15		FCI		BS, C ,203028, 169 A3	
						chr		BIJU K PAUL 2006/06/28		type		Product Customer Drawing	
						appd		BIJU K PAUL 2006/06/28					
sheet index		revision sheet		C		1							