

Detail A
Scale 5:1

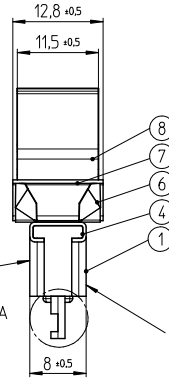
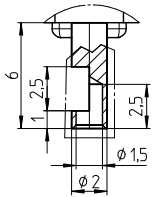

Detail A

Printing of
Logo and Rating

Date Code Printing
last digit of year
A-L = January to December
Day

ALCO ← Model No.
FLD1904
6A AC 250V ← Rating
ON - ON ← Sw. Funct.

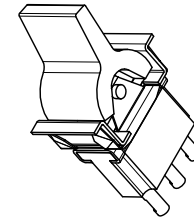
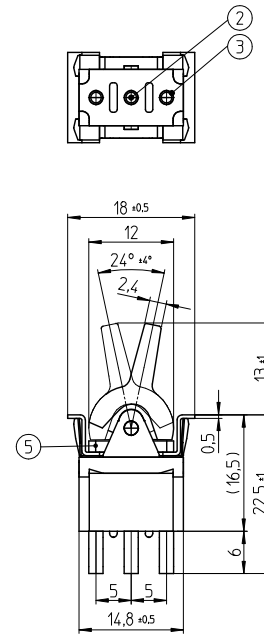

Function Chart

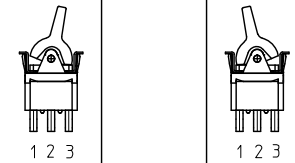

TE PN	Button	Part	Terminals 1 and 2		Terminals 2 and 3
3-6437630-2	black	FLD1904	ON		ON

Panel Cutout
thickness 1 to 2.5mm

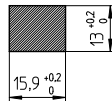

Specifications

TE PN	Part	Rating	Initial Contact Resistance	Insulation Resistance	Dielectric Strength	Endurance
3-6437630-2	FLD1904	AC 125V 6A AC 250V 6A	MAX 10 milliohms at DC 2 ~ 4V 1A	MIN 1000 M Ohms at DC 500V	AC 1kV/1min (AC 1.2kV/1sec)	electrically 50,000 cycles at 20 cycles/minute (rated load resistive) mechanically 100,000 cycles at 20 cycles/minute

Materials Chart

1	Case	Polyester Resin	Black
2	Common	C3602BD	Ep-Cu/Ni 3,Au F b
3	Fixed contact	C3602BD+Ag	Ep-Cu/Ni 3,Au F b
4	Frame	SUS	
5	Mounting Sleeve	C3602BD	Ep-Cu/Ni 3 b
6	Leaf spring	SUS	
7	Plate	SUS	
8	Button	Nyron Resin	

PART NO:	PART NAME:	MATERIAL/SURFACE:	OPTIONAL DESCRIPTION
PART LIST			
TOLERANCES UNLESS OTHERWISE SPECIFIED ACCORDING TO ISO 8015 and ISO 2768-F			DIMENSIONS: mm
<small>test dimen. / Prüfmaß: □, auxiliary dimen. / Hilfsmaß: (), theor. dimen. / theor. Maß: □, production control dimen. / Fertigungsmaß: [] , dimen. for measure. technology / messtechn. rel. Maß: []</small>			
DEPARTMENT	D&E	DATE	04.01.2007
DRAWER	SA008712	DATE	
CHECKED		DATE	
APPROVED		DATE	
ECR-NO:	DATE	NAME	INFO
SCALE:	NAME:	DWG NO:	NAME
Rocker Switch Single pole			©=1968520
Long Rocker			Customer Drawing
REPLACEMENT FOR:	DWG LOC NO:	IF SHEET: 1 OF 1	REVISION: A A 2

THIS INFORMATION IS CONFIDENTIAL AND PROPRIETARY TO TYCO ELECTRONICS AUSTRIA GMBH AND ITS WORLDWIDE SUBSIDIARIES AND AFFILIATES. IT MAY NOT BE DISCLOSED TO ANYONE OTHER THAN TYCO ELECTRONICS PERSONNEL, WITHOUT WRITTEN AUTHORIZATION FROM TYCO ELECTRONICS AUSTRIA.